

Inventory as of 04/19/2017

Dimension	Size	Qty	SqFt	Rented	Available
10'x10'	100	66	6,600	0	66
10'x20'	200	11	2,200	0	11
20'x20'	400	1	400	0	1
Totals:		78	9,200	0	78

170 72" ROUNDS OF 10 (on 12' centers)

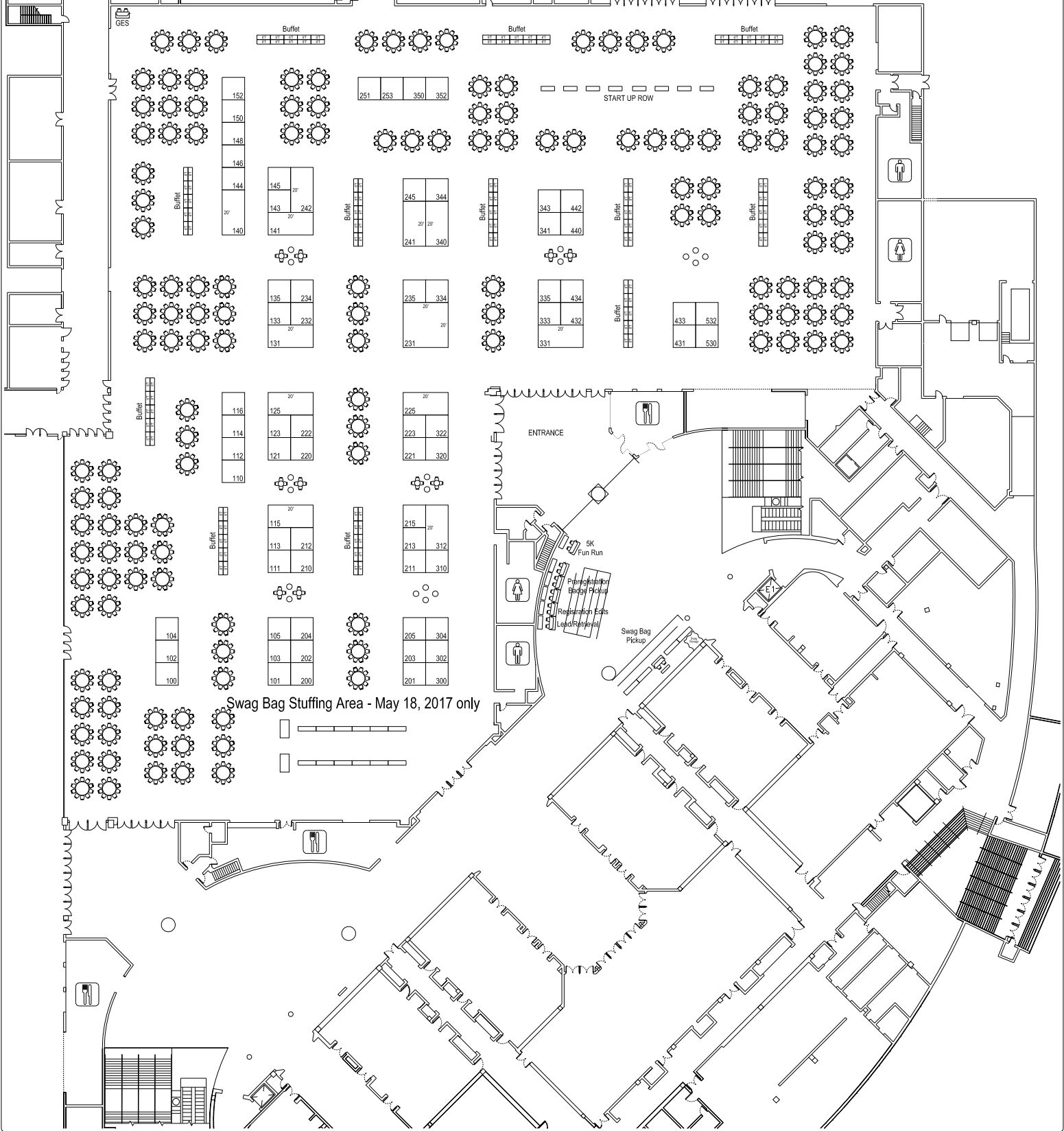

GES Global Experience Specialists

 COPYRIGHT © BY GLOBAL EXPERIENCE SPECIALISTS. ALL RIGHTS RESERVED. NO PART OF THIS PUBLICATION MAY BE REPRODUCED, STORED IN ANY RETRIEVAL SYSTEM, OR TRANSMITTED IN ANY FORM OR BY ANY MEANS - ELECTRONIC, MECHANICAL, PHOTOCOPYING, RECORDING, OR OTHERWISE - WITHOUT EXPRESS WRITTEN CONSENT OF GLOBAL EXPERIENCE SPECIALISTS.

PyCon Annual Conference 2017
May 18-20, 2017
Oregon Convention Center - Halls A, A1 & B

CONFIDENTIAL PROPERTY OF GES

 File: pycon-1708-conv-art5.dwg
 Plotted: Apr 18, 2017
 By: JAC/21

EVERY EFFORT HAS BEEN MADE TO INSURE THE ACCURACY OF ALL INFORMATION CONTAINED ON THIS FLOOR PLAN. HOWEVER, NO WARRANTIES, EITHER EXPRESSED OR IMPLIED, ARE MADE WITH RESPECT TO THIS FLOOR PLAN. IF THE LOCATION OF BUILDING COLUMNS, UTILITIES, OR OTHER ARCHITECTURAL COMPONENTS OF THE FACILITY IS A CONSIDERATION IN THE CONSTRUCTION OR USAGE OF AN EXHIBIT, IT IS THE SOLE RESPONSIBILITY OF THE EXHIBITOR TO PHYSICALLY INSPECT THE FACILITY TO VERIFY ALL DIMENSIONS AND LOCATIONS.